

## PART NO:CH-L2B05TGD-13

### ◆Features

- 5mm Round LED Lamps
- Emitting Color:Kelly
- Lens Color:Kelly Transparent
- Mertial:GaP
- Low power consumption
- Excellent product quality and reliability
- Lead-free device

### ◆Applications

- Electronic signs and signals
- Bright ambient lighting conditions
- Backlight
- General purpose indications

### ◆ Package Dimensions

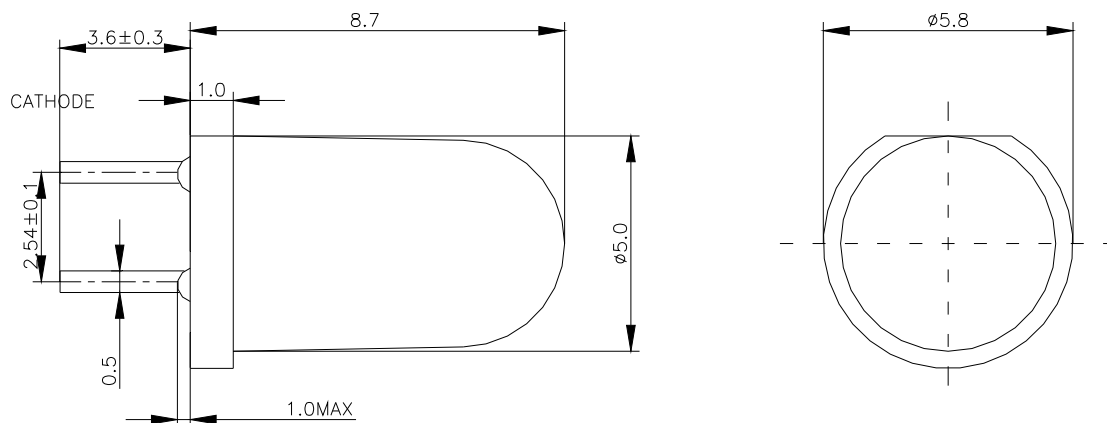

#### Notes:

1. All dimensions are in millimeters.
2. Tolerance is  $\pm 0.25$  unless otherwise noted.
3. Lead spacing is measured where the leads emerge from the package.
4. Specifications are subject to change without notice.
5. The design and working Current for Led is not less than 2mA.

### ◆ Absolute Maximum Ratings at TA=25°C

Parameter	Symbol	Value	Unit
Power Dissipation	PD	50	mW
Forward Current	IF	30	mA
Peak Forward Current*1	IFP	100	mA
Reverse Voltage	VR	5	V
Operating Temperature	Topr	-40°C To +85°C	
Storage Temperature	Tstg	-40°C To +85°C	
Soldering Temperature*2	Tsol	260°C For 5 Seconds	

Notes:

\*1: Pulse width≤0.1ms, Duty cycle≤1/10

\*2: ΔAt the position of 3mm below package base.

\*3: ▲Plese refer to the curve of forward current vs.temperature

### ◆ Electrical / Optical Characteristics at TA=25°C

Parameter	Symbol	Min.	Typ.	Max	Unit	Test Conditions
Forward Voltage	VF	—	2.10	—	V	IF=20mA
Reverse Current	IR	—	—	10	μA	VR=5V
Dominant Wavelength	λd	—	572	—	nm	IF=20mA
Peak Wavelength	λP	—	570	—	nm	IF=20mA
Spectral line Half-width	Δλ	—	15	—	nm	IF=20mA
Luminous Intensity	IV		500		mcd	IF=20mA
Power Angle	2θ1/2	—	15	—	Deg.	IF=20mA

Remarks:

If special sorting is required (e.g. binning based on forward voltage, luminous intensity, or dominant wavelength), the typical accuracy of the sorting process is as follows:

- 1.Dominant Wavelength: +/-1nm
- 2.Chromatic Coordinates: +/-0.01
3. Luminous Intensity: +/-15%

# ◆ Typical Electrical/Optical Characteristics Curves ( Ta=25°C Unless Otherwise Noted )

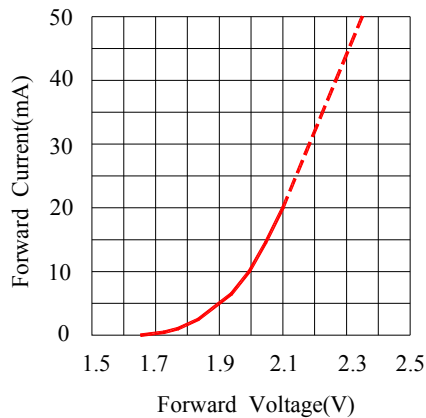

FORWARD CURRENT V<sub>s</sub>.  
FORWARD VOLTAGE

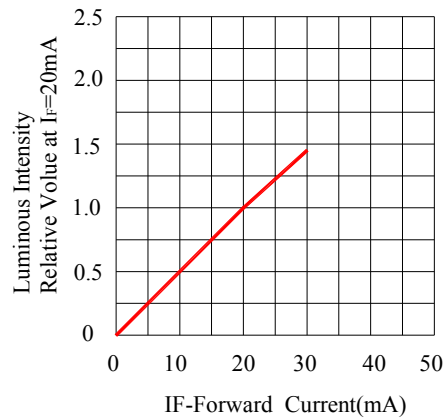

LUMINOUS INTENSITY V<sub>s</sub>.  
FORWARD CURRENT

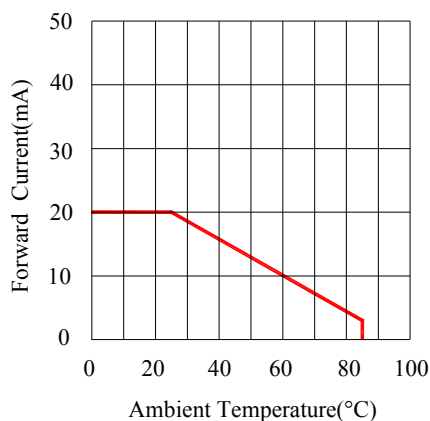

FORWARD CURRENT  
DERATING CURVE

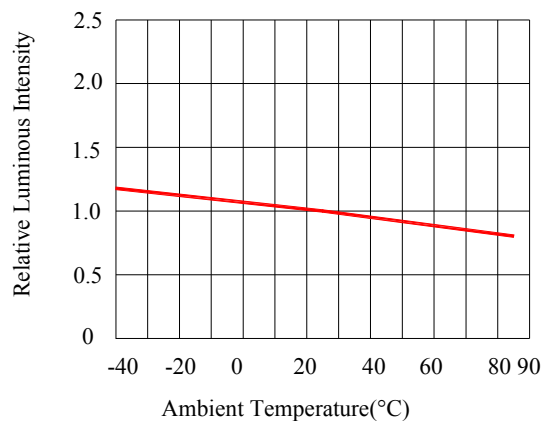

LUMINOUS INTENSITY V<sub>s</sub>.  
AMBIENT TEMPERATURE

